



常规

型号:	hr51MXGE
产品代码:	F004100
产品系列:	HR 10GigE
状态:	Available

传感器

传感器类型:	Area scan
色度:	Mono
光谱:	Visible
光谱范围:	400 nm to 1000 nm
分辨率:	8,424 × 6,032 (51.00 MP)
传感器型号:	Gpixel GMAX4651
传感器架构 (材料) :	cmos
快门类型:	global-shutter
传感器尺寸:	38.75 × 27.75 mm (47.66 mm, 35mm Full Frame)
像素尺寸:	4.60 μm × 4.60 μm

像素格式

传感器位深度:	8-Bit,12-Bit
单色像素格式:	mono8, mono12

成像性能

动态范围:	65 dB
信噪比:	42.6 dB

时序与增益

最大帧率:	23.7
曝光时间:	17 μ s to 60 s
增益:	0.0 dB to 40.0 dB

I/O与电源

非电气隔离IO:	0 x LVDS input, 0 x LVDS output, 0 x TTL input, 0 x TTL output, 2 x 24V input, 4 x Open drain output,
特定非电气隔离IO:	1 x RS232 input, 1 x RS232 output, 0 x RS422 input, 0 x RS422 output,
光电隔离线路:	1 x Optical isolated input, 0 x Optical isolated input,
电源供应:	10 to 25VDC, Power over Ethernet (POE+, in option -P)
功耗:	External: 17 W (typical)

机械特性

机身尺寸 (L x W x H mm) :	77 x 70 x 70
滤光片/保护玻璃:	N-BK7 - AR coating 380-850nm
IP防护等级:	IP30
镜头接口:	M58x0.75
重量:	380 g

板载内存与FPGA

图像缓存 (RAM) :	448 MByte
--------------	-----------

接口

数字接口:	10gige
接口连接器:	(RJ-45)

固件功能 - 图像控制

曝光模式:	Manual, Auto
增益模式:	Auto, Manual
图像控制功能:	FW Features - Image Control

固件功能 - 相机控制

触发模式/同步:

INTERNAL, SOFTWARE, EXTERNAL

相机控制功能:

User Sets, POE, PWM(4), Sequencer,

Monochrome

(not included: lens- and light source characteristics)

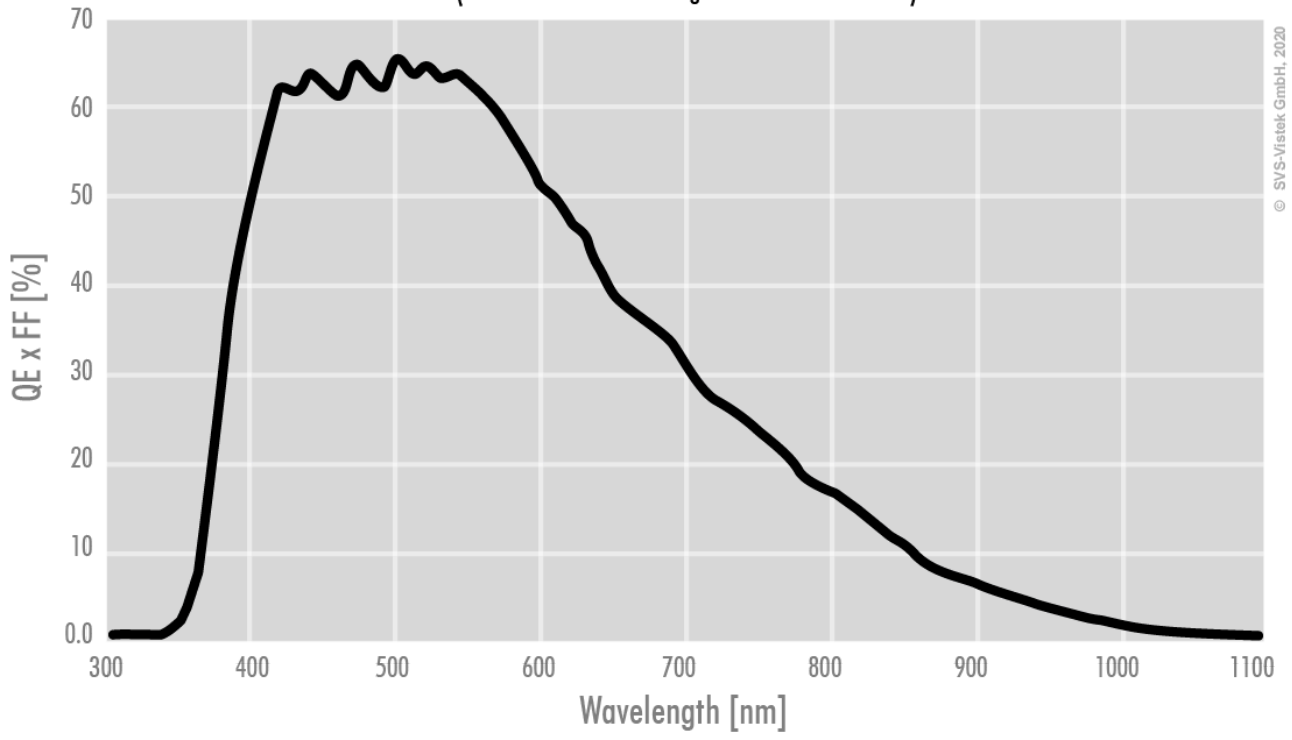

front

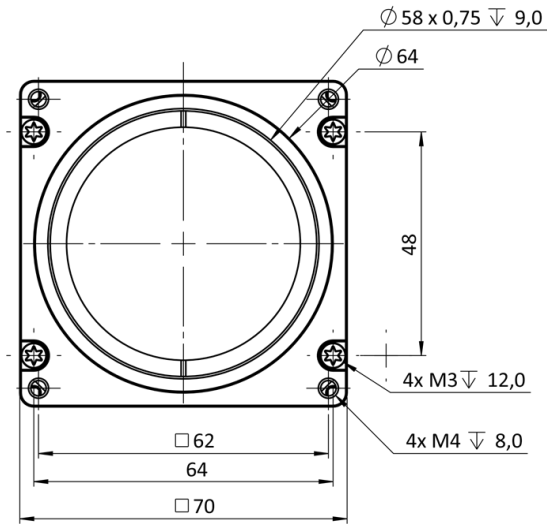

back

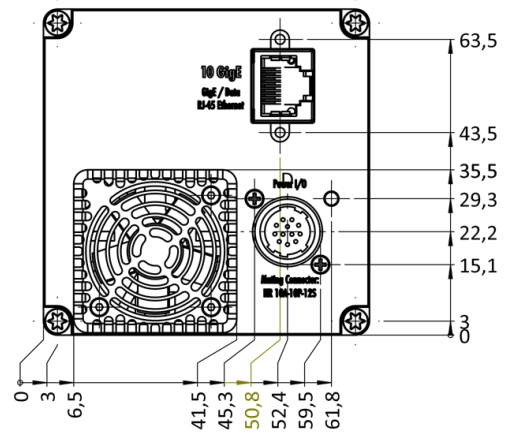

cross section

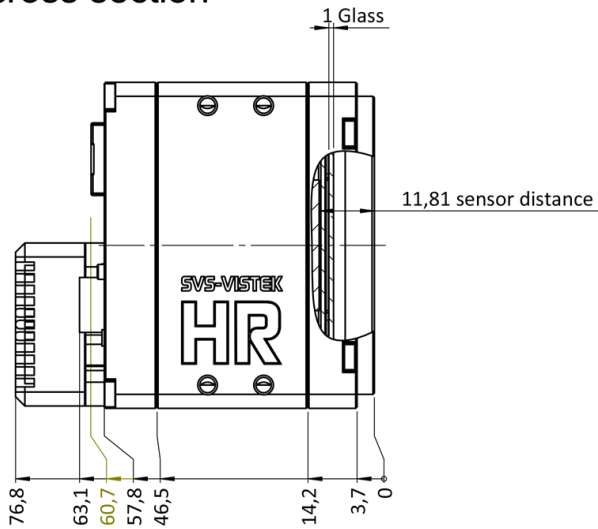

right side

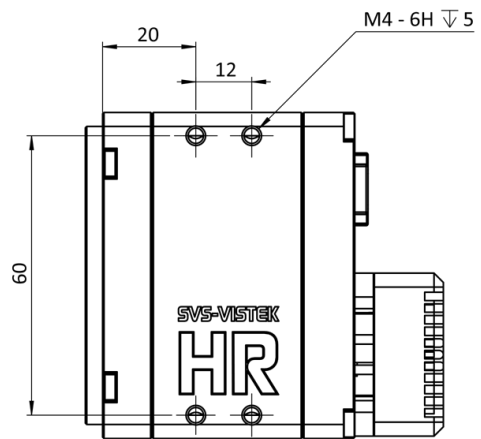

top

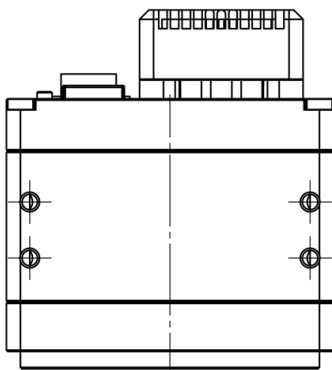

bottom

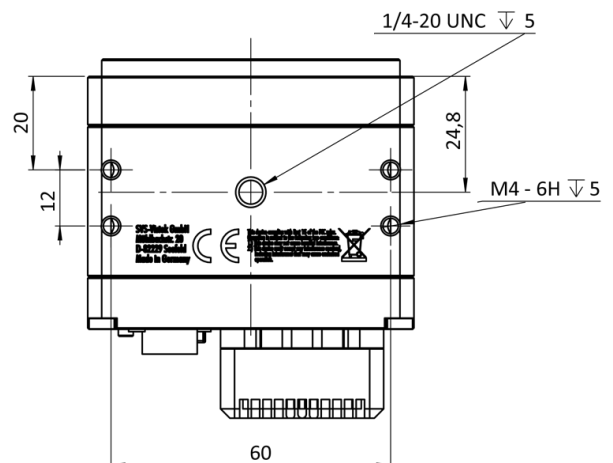

3D

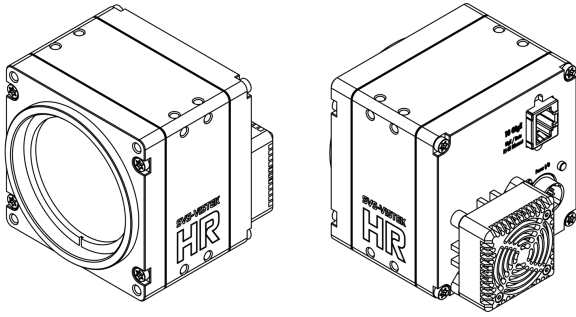

I/O pin assignment

Hirose 12 Pin



1	VIN -	(GND)	7	OUT 1	(open drain)
2	VIN +	(10 V to 25 V DC)	8	OUT 2	(open drain)
3	IN 4	(RXD RS232)	9	IN 3 +	(opto In +)
4	OUT 4	(TXD RS232)	10	IN 3 -	(opto In -)
5	IN 1	(0-24V)	11	OUT 3	(open drain)
6	IN 2	(0-24V)	12	OUT 0	(open drain)