

DATA SHEET

Tripod Adapter to M6 and 1/4-20 UNC

For housed Alvium cameras

Product code
12310/12310-02

V1.2.0
2023-Jul-12

Shipping contents

- Tripod adapter (mounting plate) for housed Alvium cameras
- 2 screws M3-8 for mounting the tripod adapter to the camera (maximum torque: 0.6 Nm)



CAUTION

Personal injury by falling cameras

A falling camera can hit your body and hurt you.

- Before mounting your Alvium camera to the tripod adapter, read your camera's user guide. See www.alliedvision.com/en/support/technical-documentation
- Use the tripod adapter only for static applications.

Dimensions

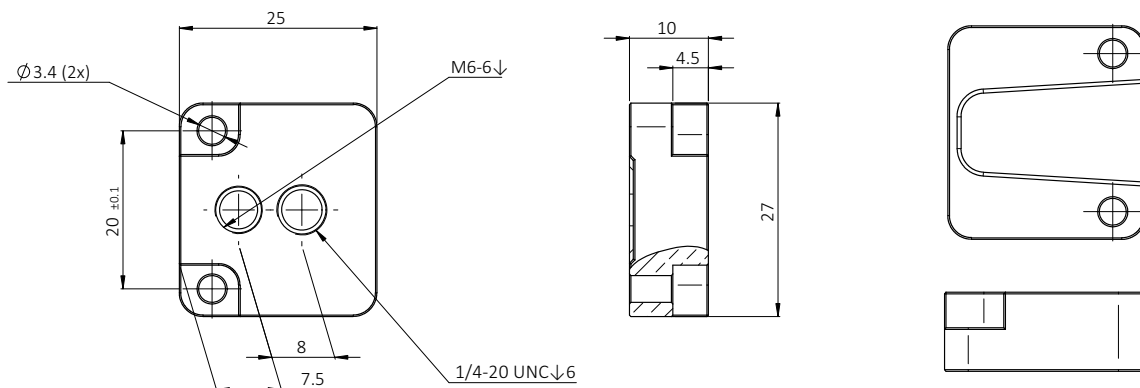

Specifications

Feature	Specification
Threads (max. torque)	1 × M6-6 ↓ (max. torque: 5 Nm*); 1 × 1/4-20 UNC ↓ 6 (max. torque: 5 Nm*)
Dimensions (L × W × H [mm])	25 × 27 × 10
Mass	16 g
Regulations	REACH
*For typical steel screws with Grade 5.2 (Festigkeit 8.8), using the full thread length	